

Little Giant®

Ladder Systems

HINGE LOCK REPLACEMENT,

READ THESE INSTRUCTIONS COMPLETELY BEFORE YOU START. IF YOU DON'T UNDERSTAND THESE INSTRUCTIONS, PLEASE CALL 800-453-1192 FOR ASSISTANCE

1. Failure to comply with all instructions may result in serious injury.
2. Make sure this kit is compatible with your ladder. Before installing this kit, identify all kit components. If any components are missing, damaged or if you have any questions concerning the use of this kit on Little Giant Ladder Systems® products, please contact our Customer Experience Team at 800-453-1192. Do not substitute any components.
3. Inspect the ladder before installing this kit. Repair or replace any damaged or missing parts before using the ladder. Use only Little Giant Ladder Systems® replacement parts. If you are unable to repair it, discard the ladder.

COMPONENTS INCLUDED

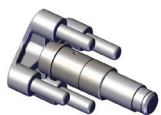

HINGE LOCK [1]



PALM BUTTON* [1]
*varies according to model.



LARGE RETAINING SNAP RING [1]



SMALL RETAINING SNAP RING [1]

TOOLS REQUIRED**

**some tools may not be needed/used



HAMMER



SNAP RING PLIERS



DRILL &
3/16" BIT



PUNCH



CHISEL



SAFETY
GLASSES

NOTE: IF ANY OTHER PART OF THE LADDER IS DAMAGED BEFORE OR DURING THE PROCESS OF INSTALLING AND/OR REPAIRING, Please contact our customer experience team for assistance at 800-453-1192.
DO NOT USE A DAMAGED LADDER!

BREAKDOWN

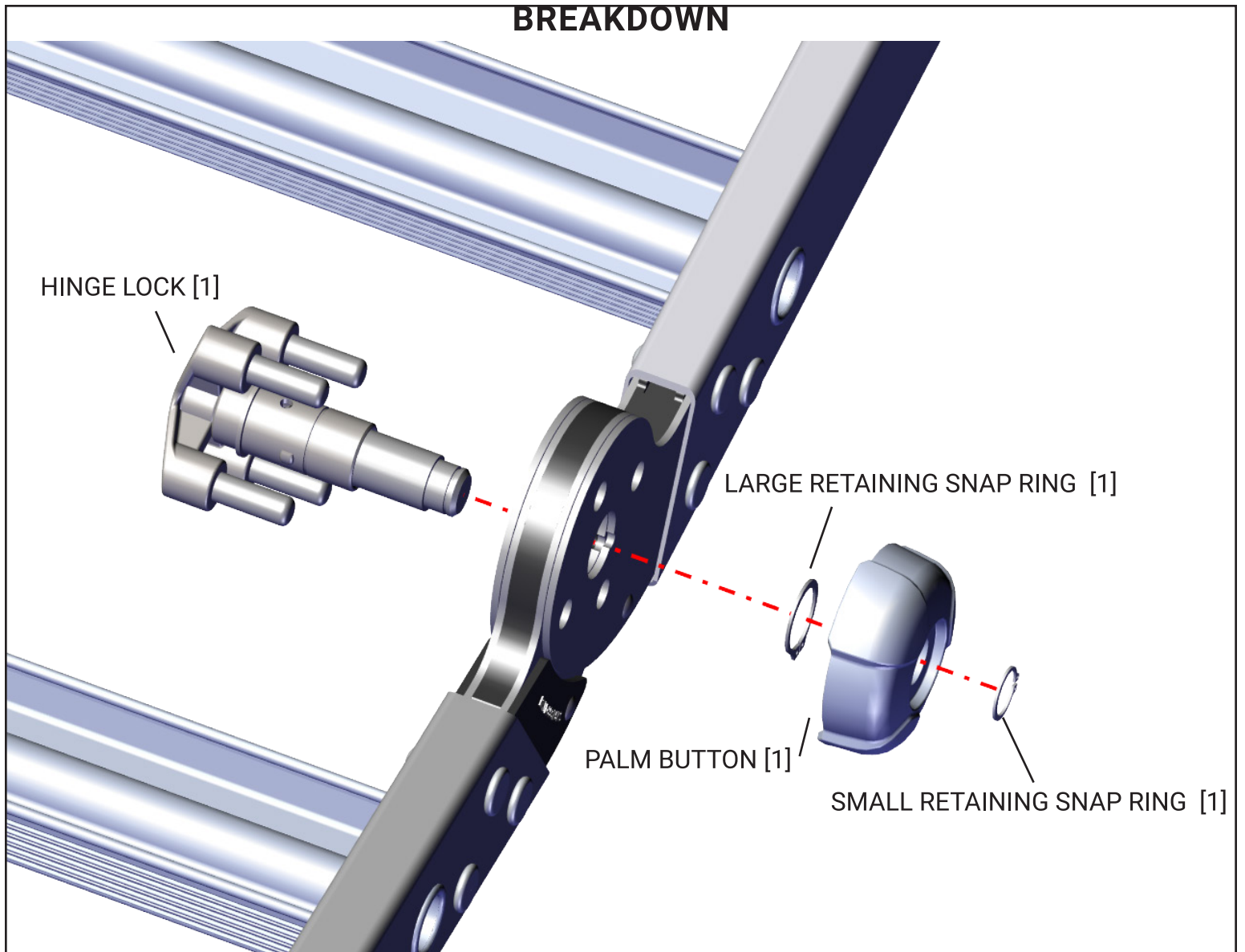

1. Remove the outer assemblies from the inner assembly.

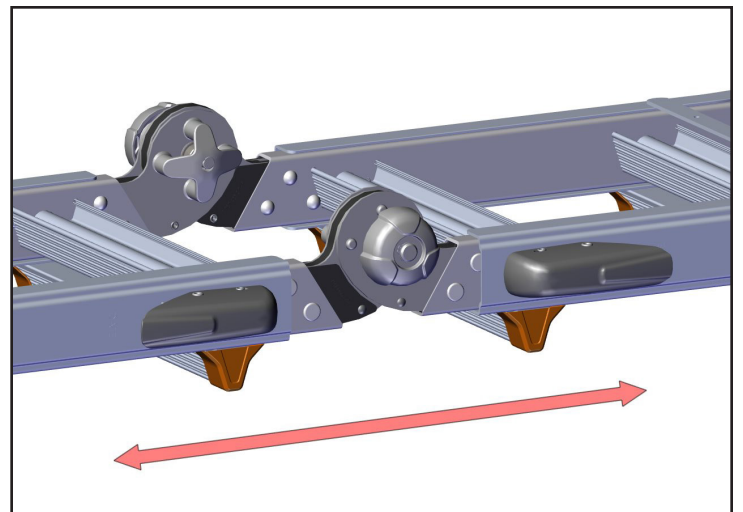

2. Open the ladder to the extended position to remove the existing hinge lock.

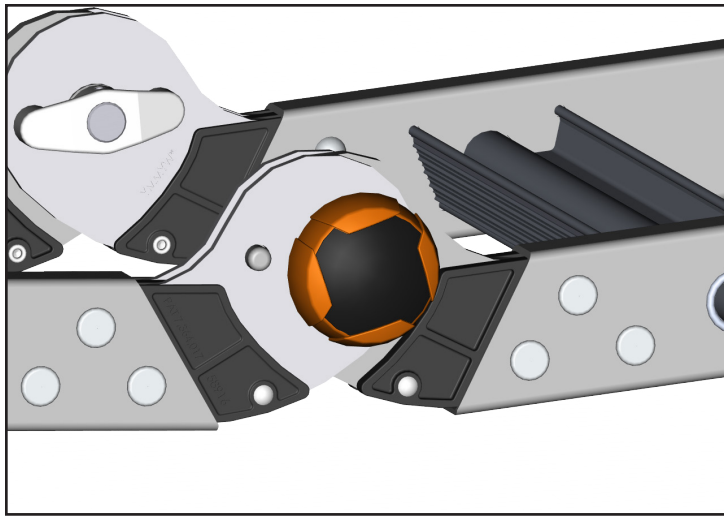

3. If the ladder has a black cap on the palm button, continue to next step. If it does not have a palm button cap skip to step 6.

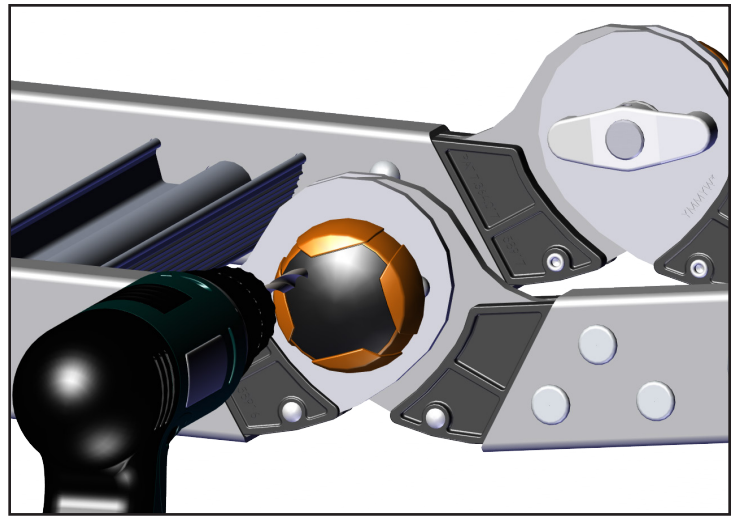

4. Using a drill and 3/16" bit, drill through one of the corners of the black cap as shown. Only drill enough to get through the black cap. If you happen to hit the orange part of the palm button it is okay, this will be discarded.

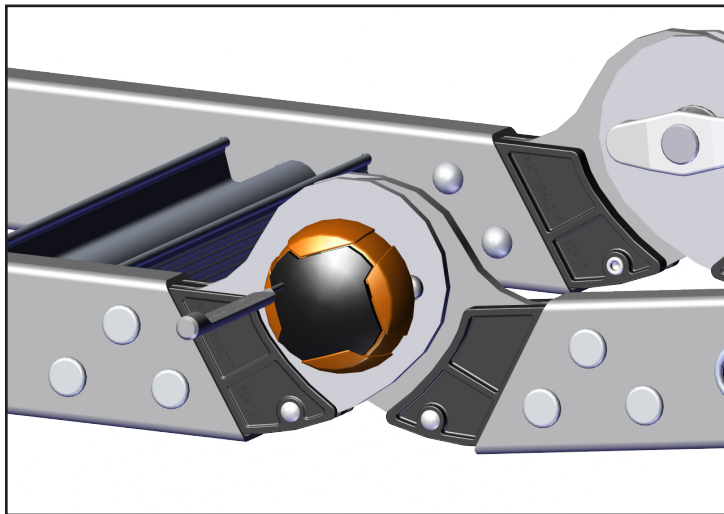

5. Use the punch to pry the cap off from the palm button. Be careful to not hurt your fingers or hands. The black cap can be discarded.

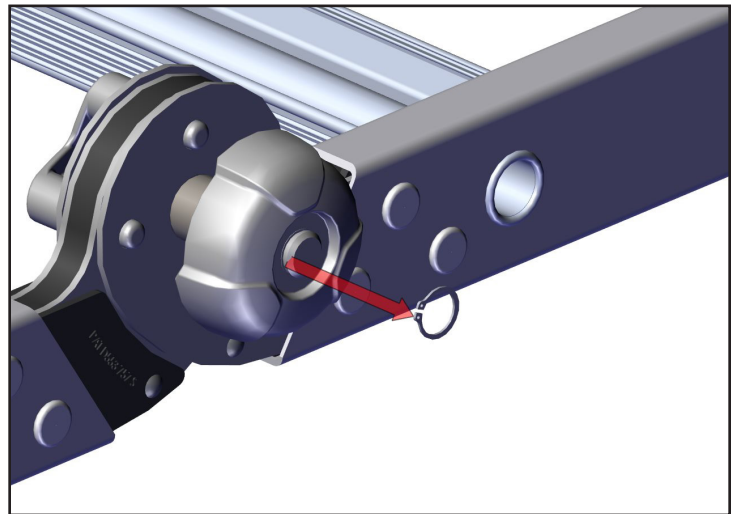

6. Use the snap ring pliers to remove the snap ring. Discard the removed snap ring.

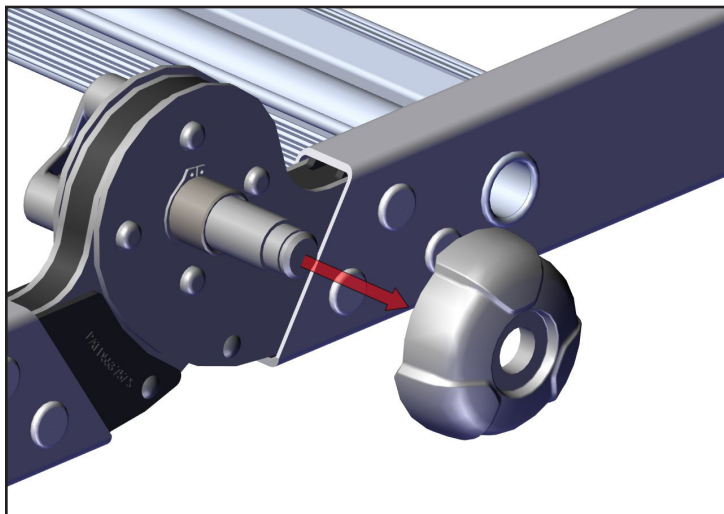

7. Remove the palm button from the shaft of the hinge lock.

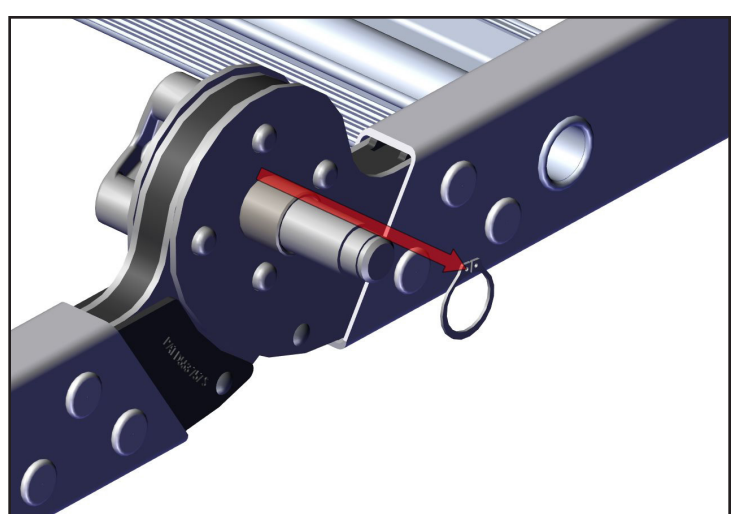

8. Use snap ring pliers to remove the snap ring. Discard the removed snap ring.

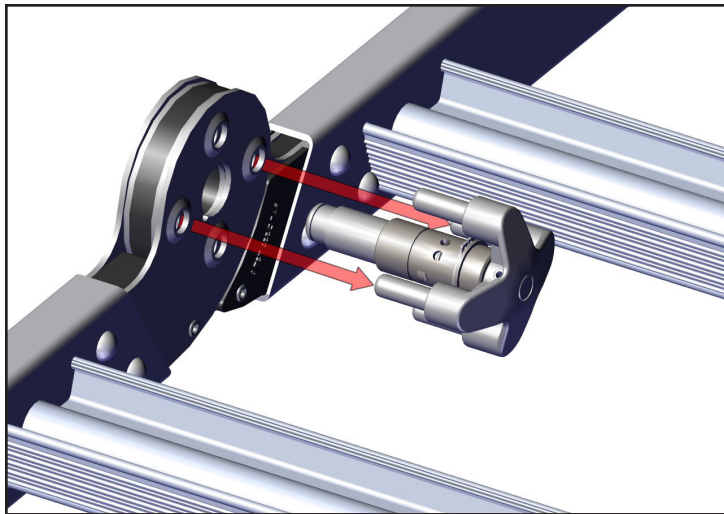

9. Pull the hinge lock from the hinge plates. Dispose of the removed hinge lock.



10. If the barrel of the hinge lock remains in the hinge plates, hit the corner of the barrel with a hammer and chisel to remove. Take care not to damage the hinge plate.

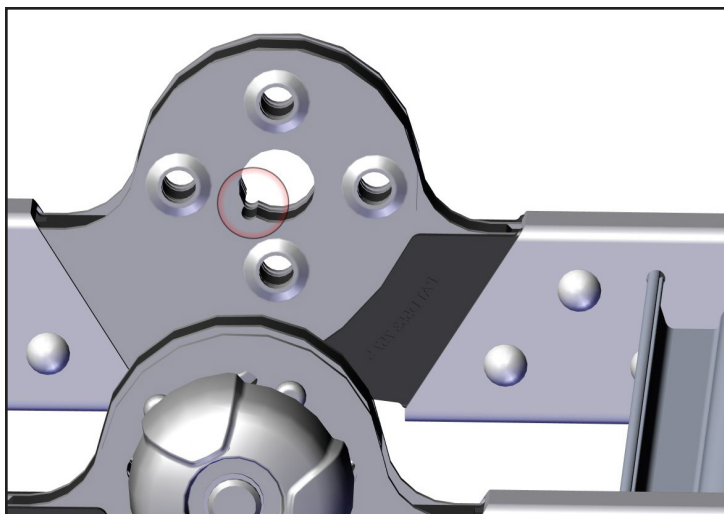

11. Notice the notch running along the bottom edge of the hole. This groove must remain in line while inserting the new hinge lock.

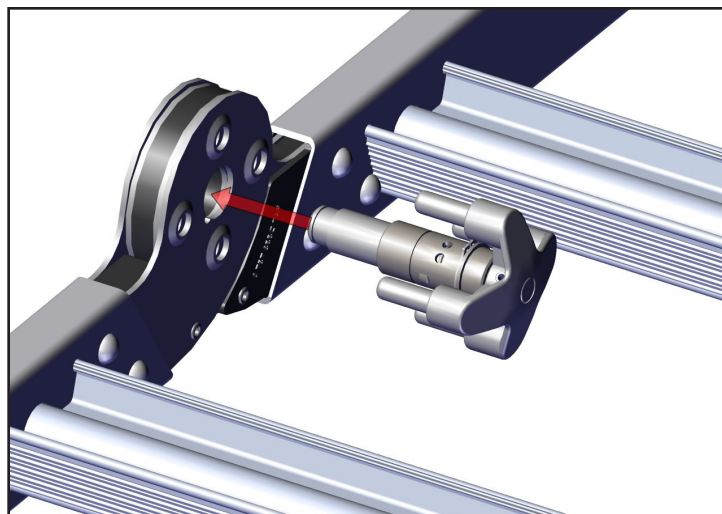

12. Insert the new hinge lock, lining up the nipple on the barrel with the notch, which goes through the center of the hinge. Also, align the four lock pins with the four holes in the hinge.

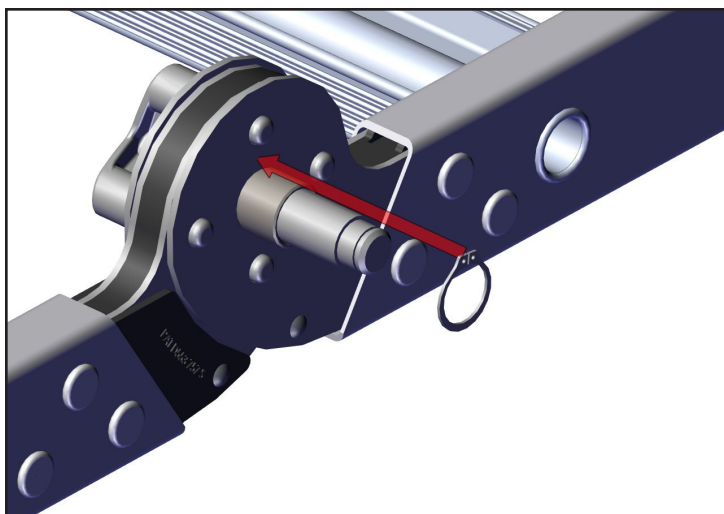

13. Only use the snap ring supplied in the kit. Install the large snap ring by placing it in the groove of the barrel. Make sure it is completely seated.

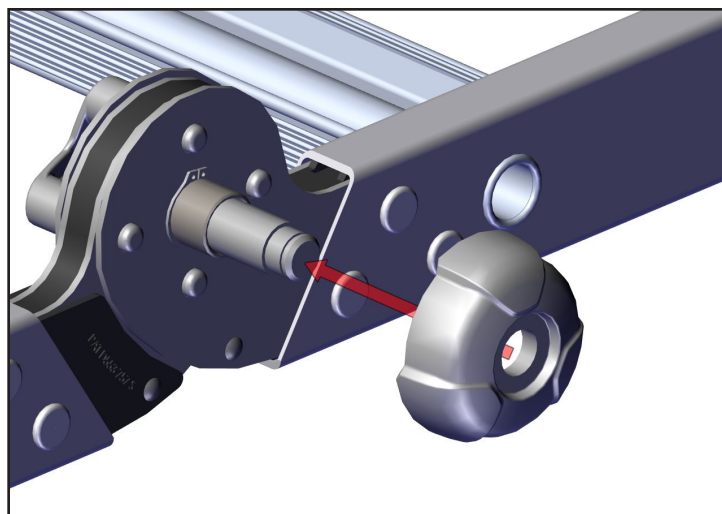

14. Replace the palm button as shown in the illustration.

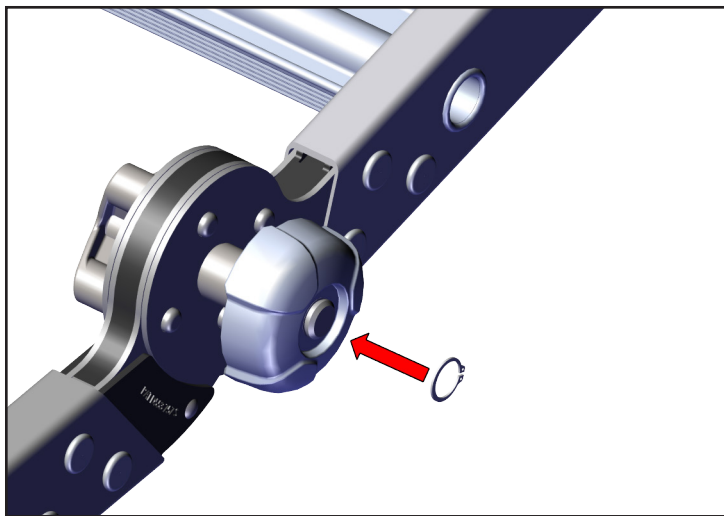

15. Replace the final (small) snap ring, making sure it is completely seated in the groove before using the hinge.

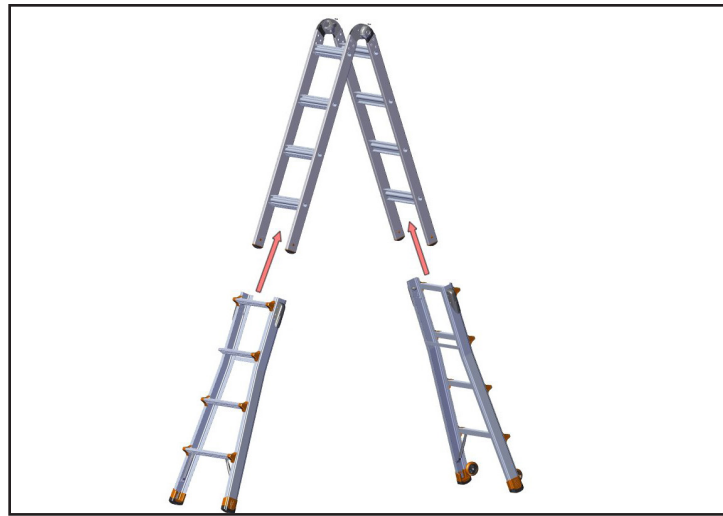

16. Re-install the outer assembly onto the inner assembly.

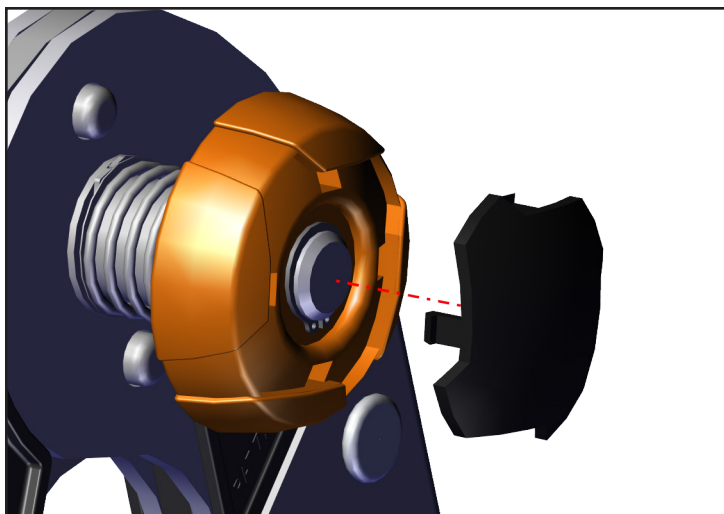

17. If applicable, align tabs on new cap with holes in palm button, then push in until tabs clip into place. Make sure all components are secure and functioning properly before returning ladder to service.